

ACURA Series



ALTIX
AUTOMA-TECH™

Smart imaging solutions

ACURA
SOLDER



Manufactured in Europe

Automatic Double Sided Exposer

Dedicated to

Soldermask/PSR

ROBUSTNESS

Stainless steel ultra rigid structure

The Acura is the result of a proven design provided by the most advanced 3D CAD system used in the industry.

The ultra rigid structure provides vibration-free stability guaranteeing accuracy is maintained year after year. The Acura will meet your highest productivity needs, with more than 5 double sided exposed panels per minute.

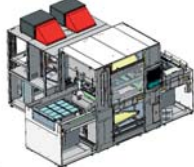

HIGH RESOLUTION & PRODUCTIVITY

HDI Capabilities



ALTIX - Automa-Tech™ concentrated its efforts to deliver an equipment able to produce High Density Interconnection (HDI) boards with all the latest fine line design technologies.

With imaging resolution down to DAM of 65µm; and drastically reduced mechanical cycle time, the Acura reaches the highest standards in resolution and productivity.

COLLIMATED LIGHT & OPTILIGHT™

Best light quality ever

ALTIX-Automatech™ boasts the most advanced collimated light in the industry. The Acura takes this to new heights: greater light uniformity over the whole image area, ultra high light intensity, best-ever improved collimation & declination angle. The goal is achieved: a resolution down to a DAM of 65µm with adequate resist and process.

OptiLight™ delivers industry's best light angle (less than 10°) for a non collimated light source.



HUMAN MACHINE INTERFACE (HMI)

Graphic User Interface & Event Logging



A state of the art touch screen graphical user interface enables easy operations, such as: quick job set ups, parameters monitoring, diagnosis and process optimization.

On-screen step-by-step instructions guide Operators through safe and error-free manufacturing.

The highly capable Event Logging feature sets industry standards for its comprehensive, real-time process control; enabling users to make right process decisions at the right time



SMALL FOOTPRINT

Double side exposure like no other

The Acura is a direct response to Customer's requests for increased productivity at the lowest cost per image. It also provides the smallest foot print possible with extra large panel capability (610 x 760mm / 24" x 30").

Whichever the light source choice: Collimated, or LED Light™, or the manufacturing process you will use with the Acura, the system will only occupy 60% of the total foot print as compared to conventional dual single sided exposer.

Dual single side exposure foot print vs Acura



WORLDWIDE SERVICE

ALTIX - Automa-Tech™ service and support



All ALTIX - Automa-Tech™ equipment from manual, semi-automatic to fully automatic exposer are backed up by an extensive service and support network.

With service and support coverage in Asia, Europe and North America, the Company has an unbeatable position to meet and exceed Customer expectations.

Multiple worldwide spare parts storage locations will ensure continued production of your equipment with excellent up time.

ACURA: DOUBLE SIDED AUTOMATIC EXPOSURE SYSTEM CHARACTERISTICS

Exposure Light Source	Light source Lamp Collimation angle	Collimated light or OptiLight™ 5kW or 8kW short arc lamp or 8kW extended arc lamp < 1.5°, OptiLight™: < 10°
Panel	Panel size Panel thickness	Up to 610 x 762mm (24" x 30") 0.05mm to 6.0mm
Productivity	Soldermask (SM)	Up to 3 per minute → Depends on process
Alignment Capabilities	Artwork to artwork Repeatability	+/- 5µm (after vacuum) +/- 3µm (after vacuum)
Resolution	HDI compatible	Min DAM of 65µm
Registration Modes		4 to 8 CCD cameras
Artwork	Change over time Glass artwork	Less than 2 minutes Compatible
Cleanliness	Overpressurized	Hepa filter, Class 100
Construction	Stainless Steel	Frame and covers (stainless steel inside machine & outside)
HMI (Human Machine Interface)	Graphic Color Interface	Multilanguage, intuitive software. Events Logging and SPC capabilities
General Utilities (Collimated Light Version)	Power supply Air supply Weight Dimensions	230/400/480 Volts, 50/60 Hz, 25kW Over 6 bar (1,5m³/min) 3350kg W: 3630mm (143") D: 3060mm (121") H: 2056mm (81") (+290mm (12") with Operator sliding door open)

Collimated Light or OptiLight™

Front view

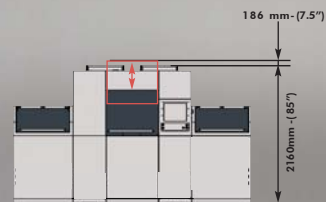

Dimensions for Collimated Light version

Top view

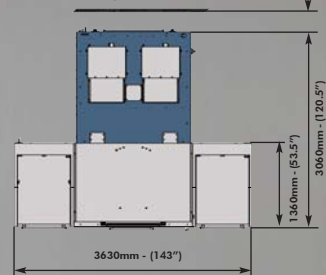

27100 Val de Reuil - France
Tel : +33 (0)2 32 63 36 36
Fax : +33 (0)2 32 63 36 37
central@altix-automatech.com
www.altix-automatech.com

Imaging with us !